

WEKOME®



WP-393·随行充系列  
多合一5000mah移动电源(适配器)

## WEKOME WP-393 Power Bank

- SKU: WP-393
- Category: Power Bank
- Description: A Power Bank combines power bank, charger and built-in cable and holder.

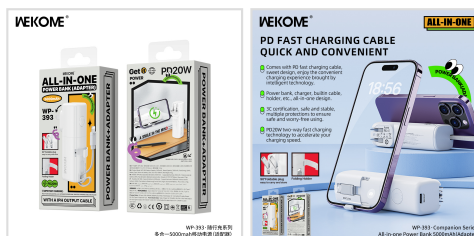

[MORE IMAGES >>](#)

### SPECIFICATIONS

Model Number	WP-393
Material	ABS+PC
Type of Battery	Lithium-ion cylindrical cell
Battery Capacity	5000mAh
Rated Capacity	2880mAh
Input Port	AC Input/Type-C
Input	ACInput:100~240VAC.50/60Hz;0.3A Max Type-C:5-2.5A,9V-2A 12V-15A(18W)
Output Ports	iPh built-in/Type-C
Output	iPh built-in:5V-2A Type-C:5V-2A; Total:5V-2A
Color	white
Product Size	31.5*37.5*106mm
Product Weight	173g
Packed Size	140*71*37mm
Packed Weight	210g
PCS/CTN	64pcs
Carton Size	38.5*35*23cm
G.W.	14.2kg
Certifications	FCC CE ROHS
Product Status	OEM available